

# VILLAGE OF GREEN ISLAND PUMPER

TID NO. 13851



## BODY

- Welded Painted Stainless Steel Body
- ROM Painted Roll Up Doors
- Rear Slide-In Ladder and Pike Pole Storage
- Storage for 8 SCBA Bottles in Wheel Wells
- In-Compartment Mounted Tool Boards
- Low Hosebed for Easy Access

## CHASSIS

- Spartan FC94 MFD with 10" Raised Roof
- Cummins ISL9 450 HP Engine
- 3000 EVS Transmission
- Seating for 6 Firefighters
- Back-Up Camera

## TANK

- 1000 Gallon UPF Tank
- ICI SL Plus Tank Gauge

## PUMP

- Hale Qmax-XS 1500 GPM Pump
- Fire Research Pump Boss Pressure Governor
- TFT XFL-NJ Monitor
- Left side: 2.5" Discharge  
2.5" Intake  
Master Intake
- Right side: 2.5" Discharge  
4" Discharge  
Master Intake
- Front Bumper Hosewell with 1.75" Discharge
- 2.5" Crosslay
- (2) 1.75" Crosslays
- Rear 2.5" Discharge
- Hosebed 2.5" Discharge

## ELECTRICAL

- Whelen 900 LED Scene Lights
- Whelen Warning Lighting
- FireTech HiViz 72" Brow Light
- Fire Research SPA530-Q20 Telescoping Lights
- ILI LED Strip Compartment Lighting

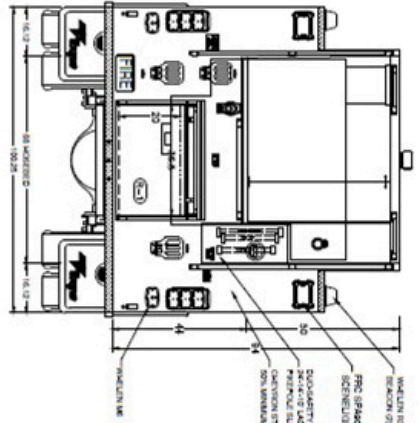

COMP.	HGT	WTH	USABLE LGTH		SPACE	FT.
			UPPER	LOWER		
CWP	67.12	35.88	1.4	2.6	7.8	26.50
RAW	37.12	63.75	1.4	—	—	19.18
PW	67.12	44.00	1.4	2.6	2.8	32.43
FRW	67.12	35.88	1.4	2.6	2.8	26.50
PW	67.12	63.75	1.4	—	—	19.18
FRW	67.12	44.00	1.4	2.6	2.8	32.43
FRW	26.00	44.00	—	2.0	—	21.35
HORN BEGS	2.0	—	—	—	—	14.15
FRONT X-LAY	1.6	—	—	—	—	73.75
MIDDLE X-LAY	1.6	—	—	—	—	73.75
REAR X-LAY	1.6	—	—	—	—	73.75

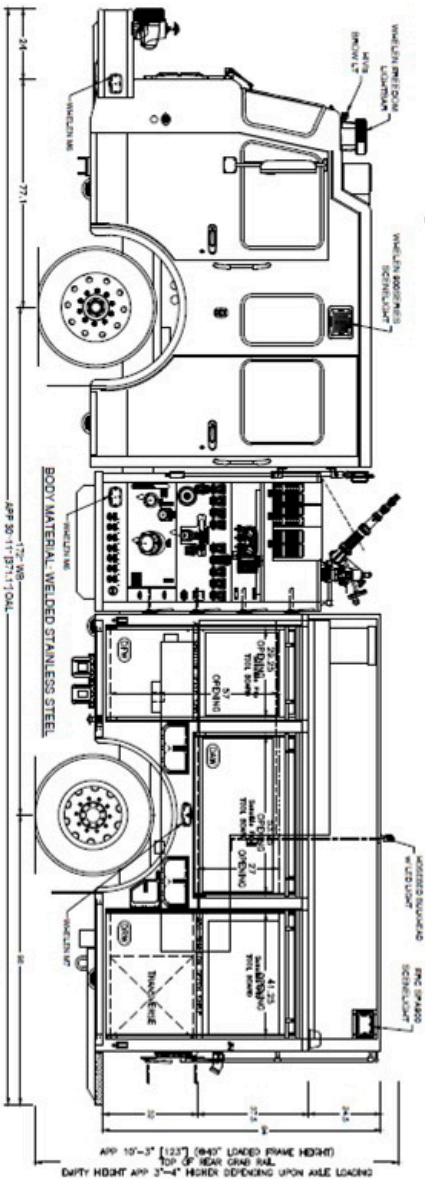
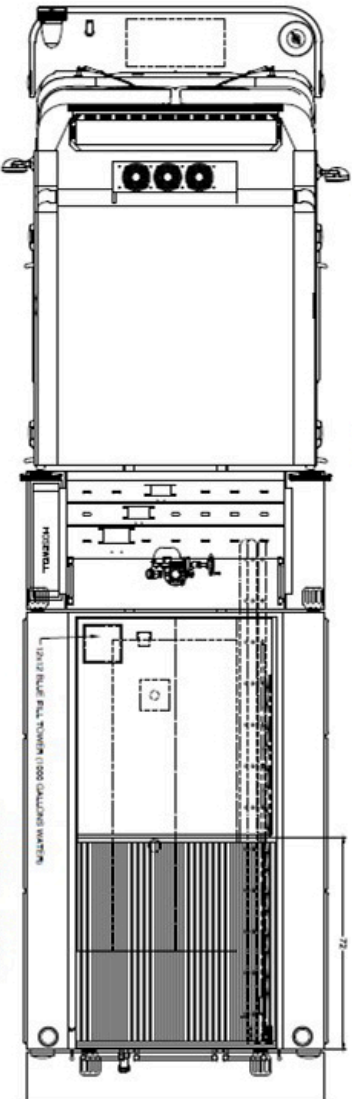
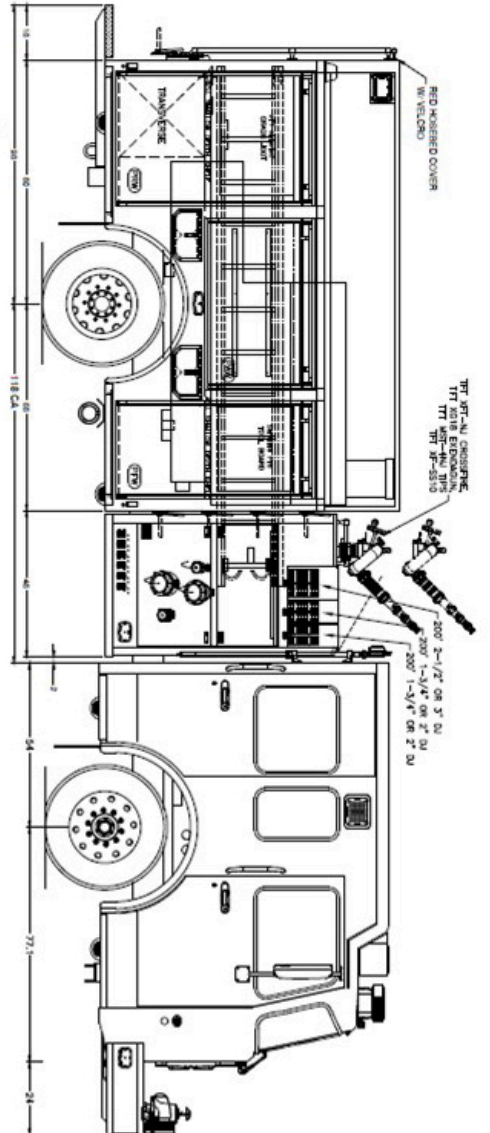
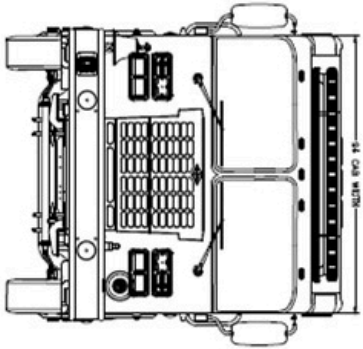

NOTE:  
 DIMENSIONS SHOWN ARE APPROXIMATE AND ARE SUBJECT TO MINOR CHANGE AS MAY BE FOUND NECESSARY DURING CONSTRUCTION. MINOR DETAILS MAY NOT BE SHOWN. DIMENSIONS ARE SUBJECT TO THE WRITTEN SPECIFICATIONS PROVIDED BY TOYNE. THE WRITTEN SPECIFICATIONS SHALL PREVAIL.

ORIGINAL DRAWING:	14MAR23	CHASSIS:	SPARTAN FC-94 MFD 10' RR	SCALE:	1:66	SHEET:	A
ISR:	24MAR23	WB-CAF:	172"-118"-47" D17	CITY:	--		
CO 1:	24MAR23	BODY MATL:	WELDED STAINLESS STEEL	STATE:	--		
AS BUILT:	14MAR24	PUMP:	HALE QMAX XS 1500	DLR:	VRS		
		TANK:	1000 T-UPF POLY-TANK III	CAD:	GROSSMAN		
		GENERATOR:	N/A	DATE:	14 MARCH 2023		
		FILE:	GREENISLAND23				

BREDA, IA 51436  
 800 648 3358  
 WWW.TOYNE.COM  
**Toyne**  
 GREEN ISLAND  
 CUSTOM PUMPER